

Hydrocyclone Filters

2" & 2½"



Features

- Reinforced Polypropylene / Nylon Construction
- Hydro dynamically designed to create maximum centrifugal action.
- Dirt can be easily flushed out through drain port.
- Stainless Steel Clamp use for fast & easy cleaning of collector tank.
- New stand for Height increase.
- Collector tank available in 8 and 10litres.
- Specially designed High wear resistant special plastic material sleeve inbuilt during molding at the bottom of cone to avoid wearing due to strong sand vortex.

Specifications	AQ-144M		AQ-145M	
	US Standard	Metric Standard	US Standard	Metric Standard
Inlet/outlet connection	2" NPT male thread	2" BSP male thread	2½" NPT male thread	2½" BSP male thread
Max. Operating Pressure	85Psi	6 kg/cm ²	85Psi	6 kg/cm ²
Range of Flow Rate	65-110 GPM	15 -25 m ³ /h	110 -175 GPM	25 -40 m ³ /h
Nominal Flow Rate	110 GPM	25 m ³ /h	130 GPM	30 m ³ /h
Material of Construction	PPGF + PAGF	PPGF + PAGF	PPGF + PAGF	PPGF + PAGF
Clamp	Stainless Steel SS-316	Stainless Steel SS-316	Stainless Steel SS-316	Stainless Steel SS-316

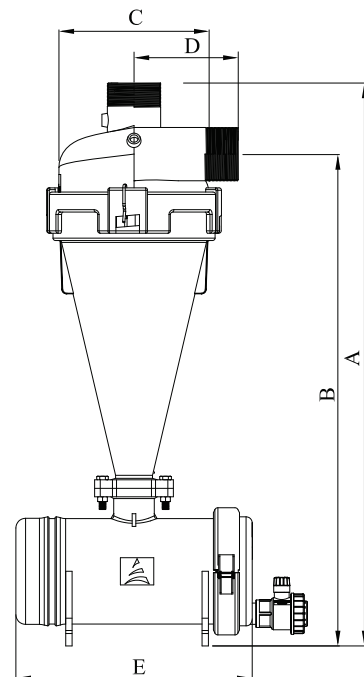
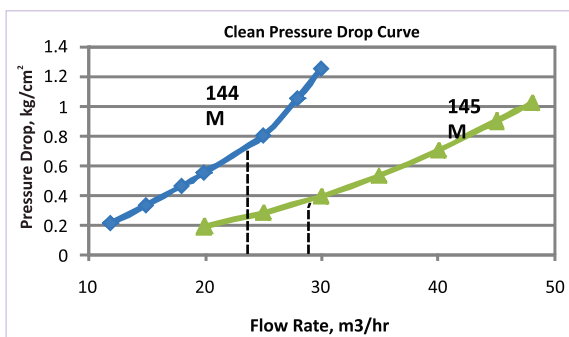

Model No.	Dimensions	
	144M	145M
Inlet / Outlet	2" / 50mm	2½" / 65mm
A	940	940
B	808	815
C	206	206
D	151	151
E	395	395
Collector Capacity, Ltr	8	8
Gross Weight, kg	7.6	7.8



E-mail: contactus@automatworld.com
 Website: www.automatworld.com

Creating a Green World